

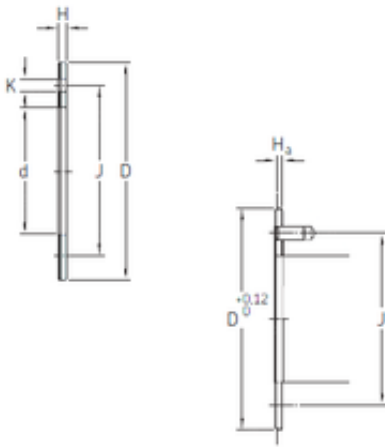

NTN Machinery Manufacturing Co., Ltd

SKF PCMW 183201.5 E plain bearings



Bearing No. PCMW 183201.5 E

PCMW 183201.5 E Bearing 2D drawings and 3D CAD models

Size	18x32x1.5 mm
Bore Diameter	18 mm
Outer Diameter	32 mm
Width	1,5 mm
d	18 mm
D	32 mm
H	1,5 mm
J	25 mm
K	2,25 mm
Ha min.	1 mm
Weight	0,0061 Kg
Basic dynamic load rating (C)	44 kN
D _a	32 mm
J _a	25 mm
H _a	1 mm
Basic dynamic load rating - radial direction C	44 kN
Basic static load rating - radial direction C ₀	137 kN
Specific dynamic load factor K	80 N/mm ²
Specific static load factor K ₀	250 N/mm ²
Factor depending on material and bearing type K _M	300
Permissible sliding velocity v max.	2 m/s



NTN Machinery Manufacturing Co., Ltd

Permissible sliding velocity v min.	0 m/s
Coefficient of friction μ max.	0.25
Coefficient of friction μ min.	0.03
Mass thrust washer	0.006 kg